

NOTES

1. LOCATION OF EXISTING PIPING AND STRUCTURES HAS BEEN PLOTTED FROM EXISTING DRAWINGS. LOCATION SHALL BE CONSIDERED APPROXIMATE.
2. THE ENTIRE PROPERTY IS LOCATED WITHIN THE MS4 AREA FOR ALLENSTOWN, NH

APPROXIMATE MAP NORTH



ENGINEER
 MICHAEL A. TRANOUE
 No. 07383
 LICENSED PROFESSIONAL ENGINEER
 STATE OF NEW HAMPSHIRE
 05/24/2021

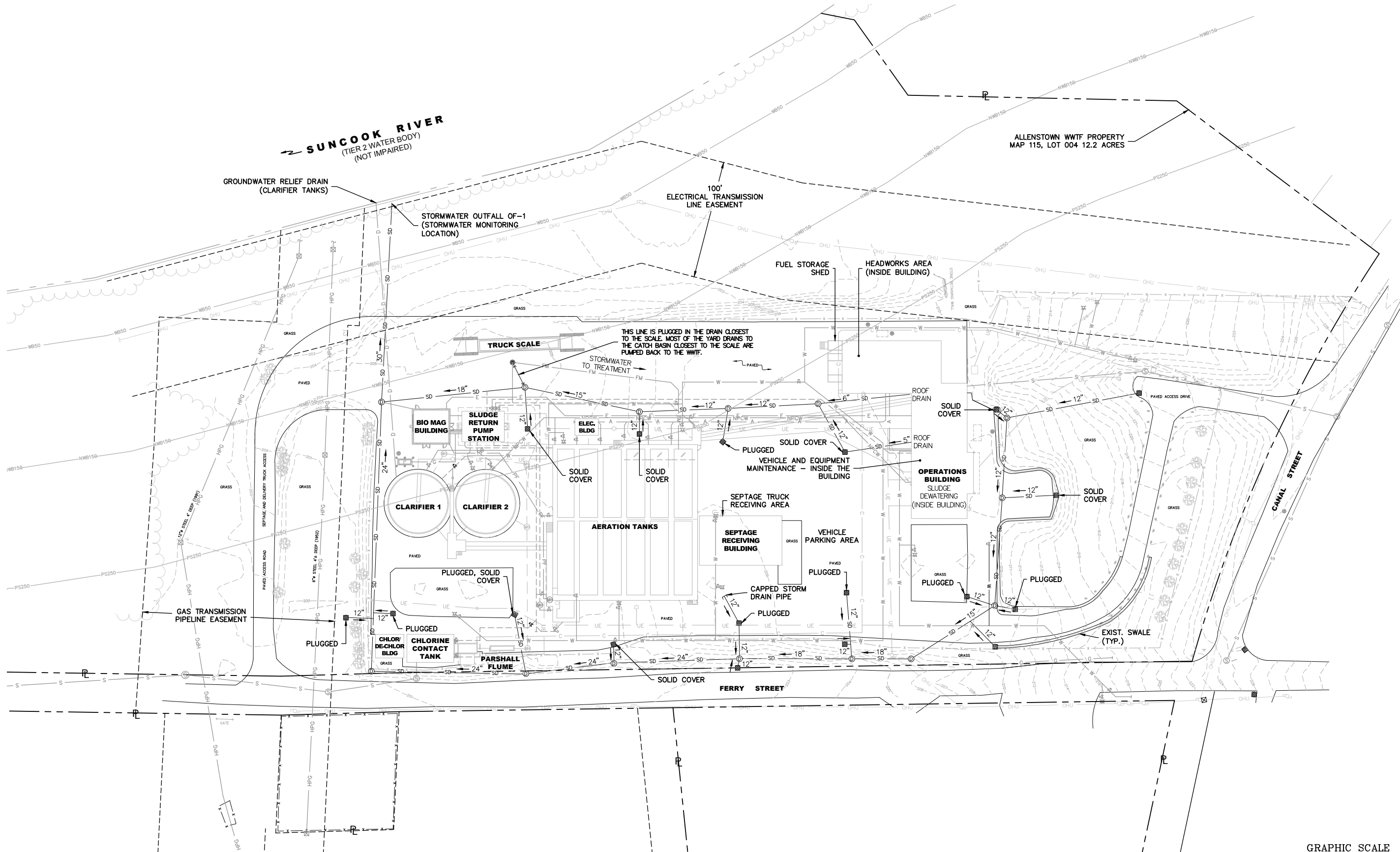

PLAN
 SCALE: 1" = 40'

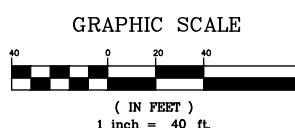

DATE	DESCRIPTION	ISSUE

HOYLE, TANNER
 PROJECT NO.
 013640
 FILE NAME
 013640_EH01

THIS DOCUMENT IS PREPARED AS A SERVICE TO THE CLIENT. IT IS THE PROPERTY OF HOYLE, TANNER & ASSOCIATES, INC. AND SHALL REMAIN THE PROPERTY OF HOYLE, TANNER & ASSOCIATES, INC. IT MAY NOT BE REPRODUCED, COPIED, OR TRANSMITTED IN ANY MANNER, INCLUDING ELECTRONICALLY, FOR ANY OTHER PURPOSE THAN THAT AUTHORIZED BY HOYLE, TANNER & ASSOCIATES, INC. WITHOUT THE WRITTEN PERMISSION OF HOYLE, TANNER & ASSOCIATES, INC.

Hoyle, Tanner & Associates, Inc.
 150 Dow Street, Manchester, NH 03101-1227
 Tel (603) 669-5555 Fax (603) 669-4168 Web: www.hoyletanner.com

DESIGNED BY: LAS
 DRAWN BY: HEM
 CHECKED BY: MAT

SCALE: AS SHOWN
 DATE: MAY 2021

TOWN OF ALLENSTOWN, NEW HAMPSHIRE
 ALLENSTOWN WWTF STORMWATER POLLUTION PREVENTION PLAN
**EXISTING
 SITE PLAN**

DRAWING NO.
1
 SHEET 1 OF 1